

Display & Control Panel

Max. RPM : 8,000 rpm
Max. RCF : 8,279 xg

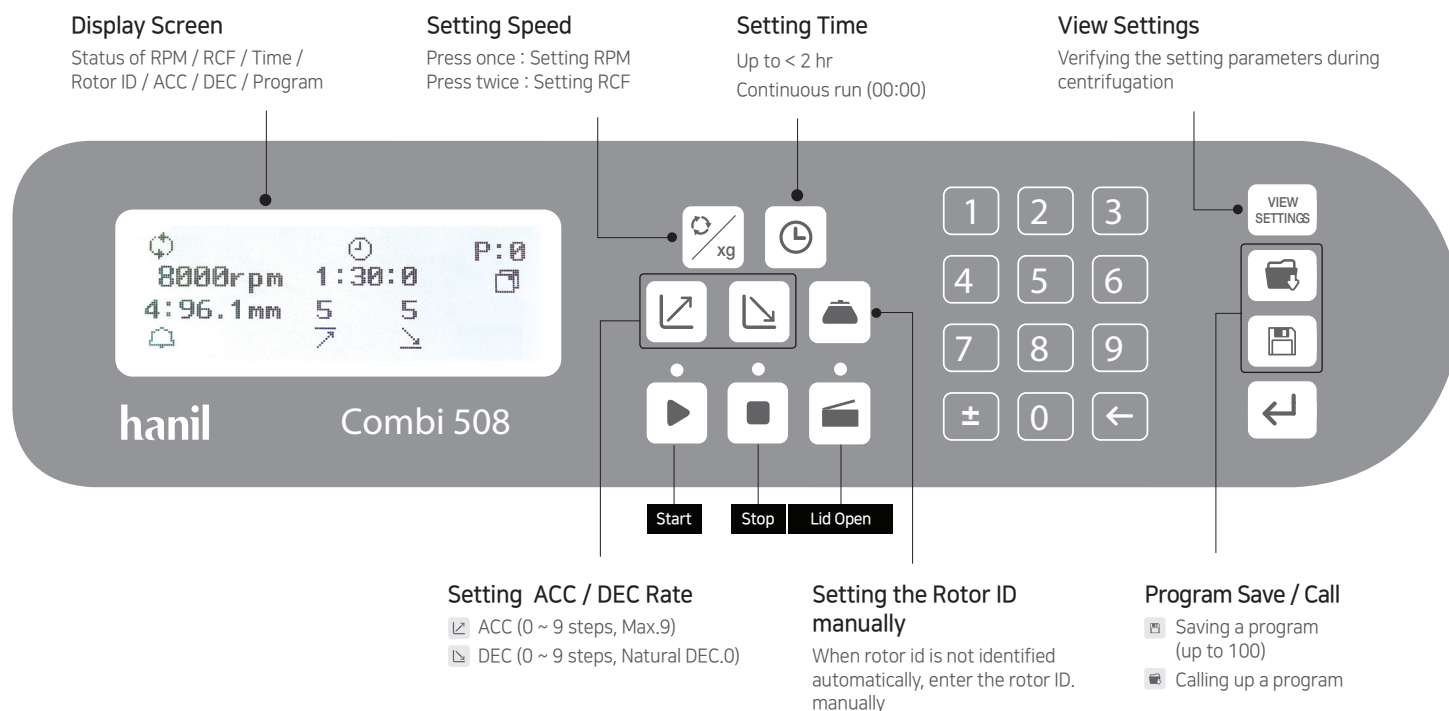

Setting Run Parameters (RPM / RCF / Time / ACC / DEC)



Press a parameter to be changed



Enter the desired value on the keypad



Press the Enter button

Saving / Calling Up a Program



Press the Save or call button



Enter the desired program number on the keypad



Press the Enter button

Cautions for Use

Before Operation

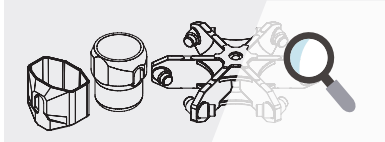

Check the Accessories for Abnormalities

Check the rotor, buckets and tubes are free of scratch and crack before operation.



Balancing the Centrifuge and Rotor

After relocating the device or loading the rotor, balance them by using a leveler. If necessary, level the device by adjusting the 'Leveling foot' on the bottom of the device.



Check the Rotor Locking

Check the rotor is firmly tightened onto the motor shaft.

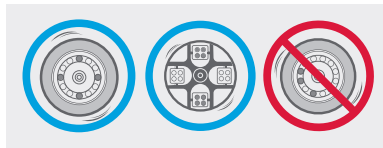

Load Tubes Symmetrically

Load tubes symmetrically into the rotor with identical amount.

After Operation



Rotor Storage

After using the rotor, remove the lid and keep it upside down. At this time, be careful not to damage the rotor ID disc.

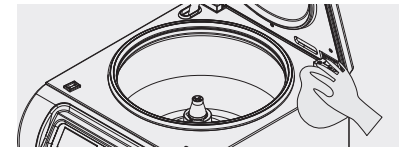

Cleaning

Clean the chamber and rotor by wiping with a cloth soaked in mild detergent and dry completely.

Maintenance

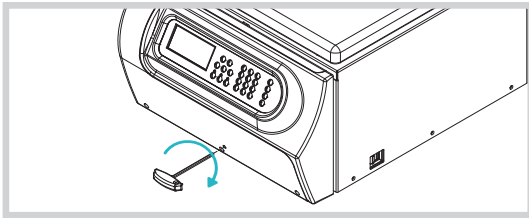

Emergency Lid Open

If the centrifuge lid cannot be opened, insert the provided T-wrench into the emergency release hole in the front of the device and turn it clockwise. (Before activating emergency open, switch off the device and wait for the rotor to stop.)

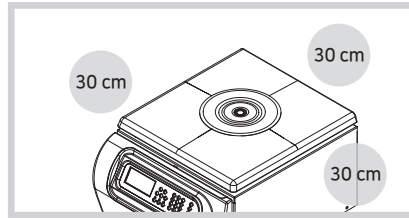

Allow a Safety Clearance of 30 cm

Allow a safety clearance of 30 cm around the centrifuge during operation.

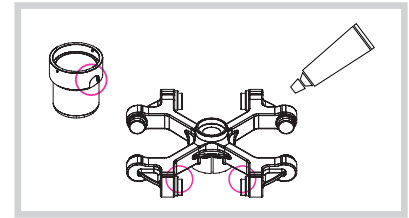

Maintenance of Swing-Out Rotor

Spread the grease lightly on the bucket where it contacts the rotor and the pivot.

Electrical Safety



Check the Line Voltage

Connect the device to voltage sources, which correspond to the electrical requirements on the label attached to the device.



Grounded Outlet

Check the wall outlet is earth-grounded, surge-protected and can supply enough power.



Switch Off the Device

Switch off the device after use. Unplug the power plug before cleaning or unused for a long period of time.

Rotors

Fixed-angle Rotors

A0.2-48	48 x 0.2 mL / Max. 8k	A15c-12	12 x 15 mL conical / Max. 8k
A2.0-24	24 x 1.5/2.0 mL / Max. 8k	A50-6	6 x 50 mL / Max. 8k
A2.0-36	36 x 1.5/2.0 mL / Max. 8k	A50c-6	6 x 50 mL conical / Max. 8k
A10-12	12 x 10 mL / Max. 8k	A50-8	8 x 50 mL / Max. 8k
A15-12	12 x 15 mL / Max. 8k	A85-6	6 x 85 mL / Max. 8k

Swing-out Rotors

S750-4	4 x 750 mL / Max. 4k
S500-4	4 x 500 mL / Max. 4k