

## Display & Control

Max. RPM	4,000 rpm
Max. RCF	2,075 xg
Timer	< 100 min or continuous

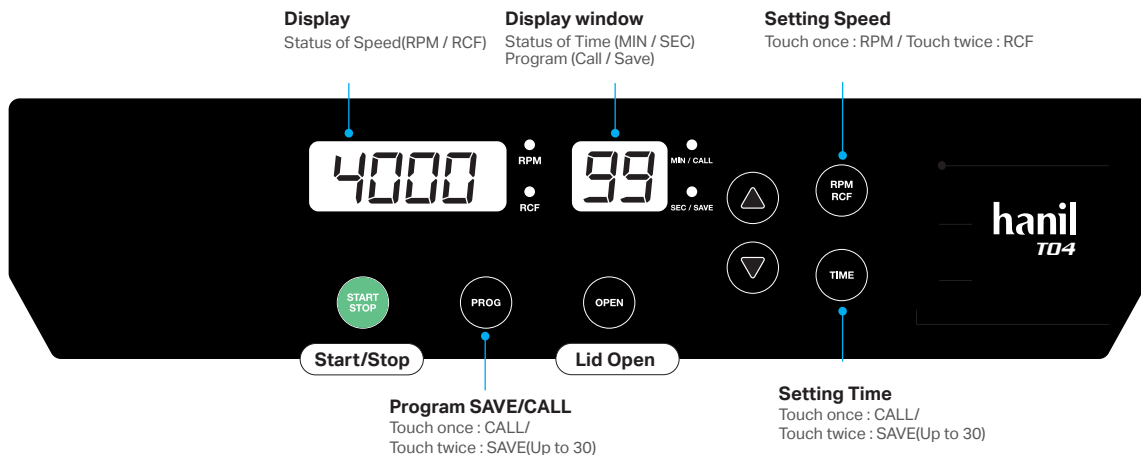

### Setting RPM / RCF, Time, ACC / DEC



Touch RPM / RCF,  
Time, ACC / DEC

Set the desired values by  
touching the Up, Down button

### Program SAVE / CALL



Touch the Up, Down button to set the desired program number  
Touch once : CALL / Touch twice : SAVE(Up to 30)

## Cautions For Use

### Before Operation



#### Check the Accessories for Abnormalities

Check the rotor, buckets and tubes are free of scratch and crack before operation.



#### Check the Rotor Locking

Check the rotor is firmly tightened onto the motor shaft.



#### Balancing the Centrifuge and Rotor

After relocating the device or loading the rotor, balance them by using a leveler. If necessary, level the device by adjusting the Leveling foot on the bottom of the device.

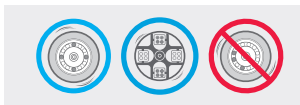

#### Load Tubes Symmetrically

Load tubes symmetrically into the rotor with identical amount.

### After Operation

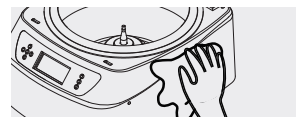

#### Cleaning

Clean the chamber and rotor by wiping with a cloth soaked in mild detergent and dry completely.



#### Keep the Chamber Dry

Wipe up the moisture in the chamber with a dry cloth after use. Keep the lid open when not in use.

## Maintenance

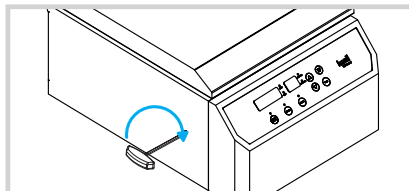

#### Emergency Lid Open

If the device door cannot be opened, you can activate the emergency open manually. 1. Wait for rotor to stop before activating the emergency open. 2. Insert the pin into the emergency open hole and push it until the door is opened.

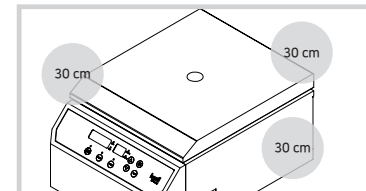

#### Keep a Safety Clearance

Keep a safety clearance of 30 cm around the centrifuge during operation.

## Electrical Safety



#### Check the Line Voltage

Connect the device to voltage sources which correspond to the electrical requirements on the label attached to the device.



#### Grounded Outlet

Check the wall outlet is earth grounded, surge-protected and can supply enough power.



#### Switch Off the Device

Switch off the device after use. Unplug the power plug before cleaning or unused for a long period of time.

## Rotor

### Fixed-angle Rotors

AO-15/10-12 6 x 15 mL or 12 x 10 mL / Max. 4k